

DOOR STOPS & HOLDERS

GENERAL HARDWARE

FLEXIBLE WALL-MOUNTED DOOR STOPS

3515



3515C15

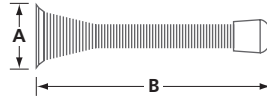

- For interior use
- Flexible steel spring
- Includes wood screw

FINISHES
15 Satin nickel

MODEL	FINISH	øA	B	/BOX	/CASE
3515	-15	$\frac{15}{16}$ (23.8)	3 (76)	50	500

IN (MM)

RIGID WALL-MOUNTED DOOR STOP

6131



6131-15

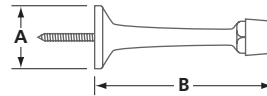

- For interior use
- Solid brass
- Integrated wood screw

FINISHES
15 Satin nickel

MODEL	FINISH	øA	B	/BOX	/CASE
6131	-15	1 (25.4)	3 (76)	25	250

IN (MM)

CONVEX & CONCAVE WALL-MOUNTED DOOR STOP

C231, C233



C231-26D



C233-26D

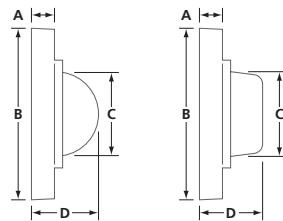

- Zinc die-cast
- Non-marking rubber
- Concealed mounting screws
- Includes wood screw, drywall anchors

FINISHES
26D Satin chrome

MODEL	FINISH	A	øB	øC	D	/BOX	/CASE
C231	-26D	$\frac{5}{16}$ (7.9)	2½ (64)	$\frac{15}{16}$ (33.3)	1 (25.4)	25	250
C233	-26D	$\frac{5}{16}$ (7.9)	2½ (64)	$\frac{15}{16}$ (33.3)	1 (25.4)	25	250

IN (MM)

DOOR STOPS & HOLDERS

GENERAL HARDWARE

DOMESTOP-LOW

C200



C200-26D

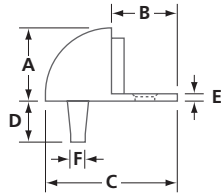

- For use with low or no threshold
- Heavy-duty zinc die-cast
- Non-marking rubber stop
- Includes wood screw and plastic anchor

FINISHES
26D Satin chrome

#T201 Riser allows easy conversion to threshold or carpet use



T201-26D
RISER

MODEL	FINISH	A	B	øC	D	E	øF	/BOX	/CASE
C200	-26D	1 (25.4)	7/8 (22.2)	1 3/4 (44.5)	3/4 (19.1)	3/32 (2.4)	3/16 (4.8)	10	200
T201	-26D	—	—	1 3/4 (44.5)	—	1/4 (6.4)	—	50	500

IN (MM)

DOMESTOP-HIGH

C218



C218-26D

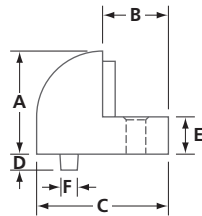

- For use with a threshold or undercut doors
- Heavy-duty zinc die-cast
- Non-marking rubber stop
- Includes wood screw and plastic anchor

FINISHES
26D Satin chrome

MODEL	FINISH	A	B	øC	D	E	øF	/BOX	/CASE
C218	-26D	1 7/16 (36.5)	7/8 (22.2)	1 3/4 (44.5)	3/4 (19.1)	1/2 (12.7)	3/16 (4.8)	10	200

IN (MM)

DOMESTOP-UNIVERSAL

C229



C229-26D

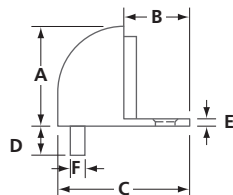

- For use with or without threshold
- Heavy-duty zinc die-cast
- Non-marking rubber stop
- Includes wood screw and plastic anchor

FINISHES
26D Satin chrome

MODEL	FINISH	A	B	øC	D	E	øF	/BOX	/CASE
C229	-26D	1 7/16 (36.5)	1 3/16 (20.6)	1 3/4 (44.5)	7/16 (11)	1/8 (3.2)	7/32 (5.6)	10	200

IN (MM)

DOOR STOPS & HOLDERS

GENERAL HARDWARE

FLOOR-MOUNTED DOOR STOP

R470



R470-26D

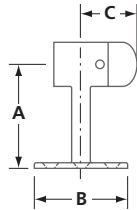

- For exterior / interior use
- Solid brass
- Non-marking rubber tip
- Includes wood screws

FINISHES

- 26D Satin chrome
- 3 Polished brass

#R470REP - Replacement rubber tip

MODEL	FINISH	A	øB	C	/BOX
R470	-26D, -3	2½ (64)	2¾ (56)	1½ (33.3)	12

IN (MM)

FLOOR-MOUNTED DOOR STOP WITH HOOK

R472



R472-26D

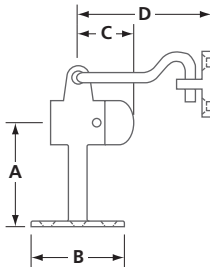

- For exterior / interior use
- Solid brass
- Non-marking rubber tip
- Includes wood screws

FINISHES

- 26D Satin chrome
- 3 Polished brass

#R470REP - Replacement rubber tip

MODEL	FINISH	A	øB	C	D	/BOX
R472	-26D, -3	2½ (64)	2¾ (56)	1½ (33.3)	2¾ (70)	10

IN (MM)

DOOR STOPS & HOLDERS

GENERAL HARDWARE

WALL-MOUNTED DOOR STOP

R474

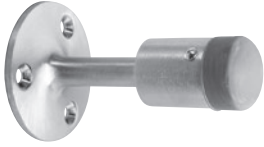

R474-26D

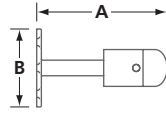

- For exterior / interior use
- Solid brass
- Non-marking rubber tip
- Includes wood screws

FINISHES

- 26D Satin chrome
- 3 Polished brass

#R470REP - Replacement rubber tip

MODEL	FINISH	A	øB	/BOX
R474	-26D, -3	3½ (89)	2¾ (56)	12

IN (MM)

WALL-MOUNTED DOOR STOP WITH HOOK

R476, R477



R476-26D

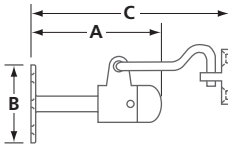

- For exterior / interior use
- Solid brass
- Non-marking rubber tip
- Includes wood screws

FINISHES

- 26D Satin chrome
- 3 Polished brass

#R470REP - Replacement rubber tip

MODEL	FINISH	A	øB	C	/BOX
R476	-26D, -3	3½ (89)	2¾ (56)	5¼ (133.4)	12

IN (MM)

DOOR STOPS & HOLDERS

GENERAL HARDWARE

PLUNGER TYPE DOOR HOLDER

1015.02



1015.02

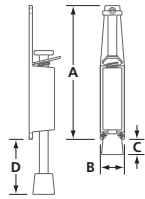

- Heavy duty zinc die-cast
- Non-marking rubber tip

#1015REP - Replacement rubber tip

MODEL	FINISH	A	B	C	D	/BOX
1015.02	Silver Paint	6½ (165)	1¾ (30.2)	7/16 (11.1)	2¾ (60)	6

IN (MM)

PLUNGER TYPE DOOR HOLDER

1026.02

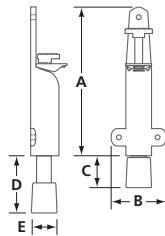

- Steel construction
- Non-marking rubber tip

#1026.00 - Replacement rubber tip

MODEL	FINISH	A	B	C	D	E
1026.02	Silver Paint	6¾ (172)	2½ (63.5)	1½ (38.1)	2¾ (70)	1½ (28.6)

IN (MM)

KICK-DOWN DOOR HOLDERS

17, 18-5



17-26D



18-5-26D

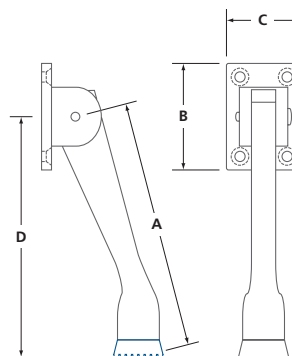

- FINISHES**
- 26D Satin chrome
 - 3 Polished brass

MODEL	FINISH	MATERIAL	A	B	C	D	REPLACEMENT TIP	SCREWS*	/BOX
17	-26D	Zinc die-cast	5 (127)	2 (50.8)	1¾ (34.9)	4¾ (121)	#17REP	Wood	10
18-5	-20D, -26D, -3	Brass	5 (127)	2 (50.8)	1¾ (34.9)	4¾ (121)	#18REP	Wood	12

IN (MM) (*) SCREWS INCLUDED

DOOR STOPS & HOLDERS

GENERAL HARDWARE

MAGNETIC DOOR HOLDER AND STOP

MDH



SMDH-26D

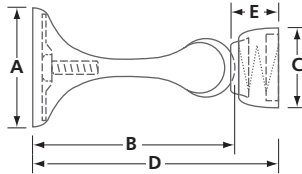

- Floor or wall mountable
- Zinc die-cast material
- Spring loaded stop
- Concealed mounting
- Mounting hardware included: wood screws

MODEL	FINISH	A	B	C	D	E	/CASE
SMDH	-15, -26D, -3	1 $\frac{3}{4}$ (44.5)	3 (76)	1 $\frac{3}{16}$ (30)	3 $\frac{3}{8}$ (93)	$\frac{3}{4}$ (19)	10
IN (MM) 15: SATIN NICKEL 26D: SATIN CHROME 3: POLISHED BRASS							

DOOR STOPS & HOLDERS

GENERAL HARDWARE

CHECK CHAINS

3548, 3550

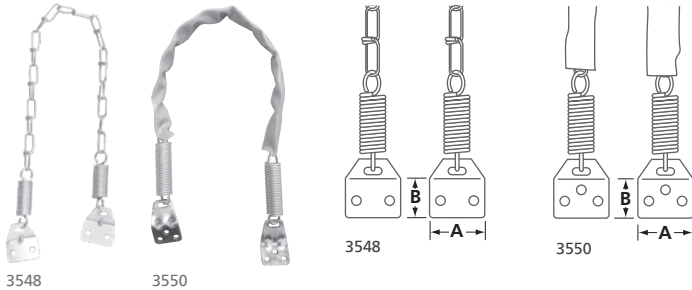

- Steel chain
- Two tension coil springs
- Stamped steel mounting brackets, zinc plated
- Mounting hardware included: self-tapping screws

#3550 - Includes grey vinyl cover, with two expansion rings

MODEL	FREE LENGTH	A	B	PER BOX
3548	24½ (622.3)	1½/16 (33.3)	7/8 (22.2)	25
3550	27½ (698.5)	1¼ (31.8)	1½/8 (28.5)	10

IN (MM)

COMMERCIAL CHECK CHAINS

3560, 3561

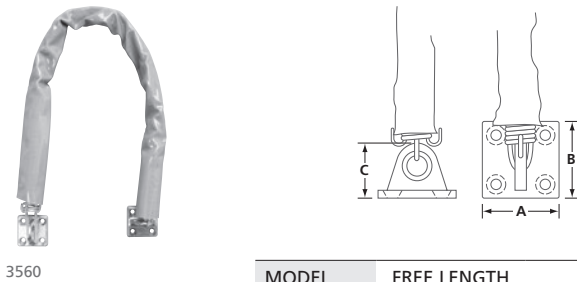

- Heavy-duty welded chain
- Two compression coil springs
- Zinc die-cast mounting brackets, zinc plated
- Grey vinyl cover
- Mounting hardware included: self-tapping screws

MODEL	FREE LENGTH	A	B	C	PER BOX
3560	27 (685.8)	19/16 (39.7)	19/16 (39.7)	1½/8 (28.6)	6
3561	31 (787.4)	19/16 (39.7)	19/16 (39.7)	1½/8 (28.6)	6

IN (MM)

HEAVY DUTY COMMERCIAL CHECK CHAIN

3562

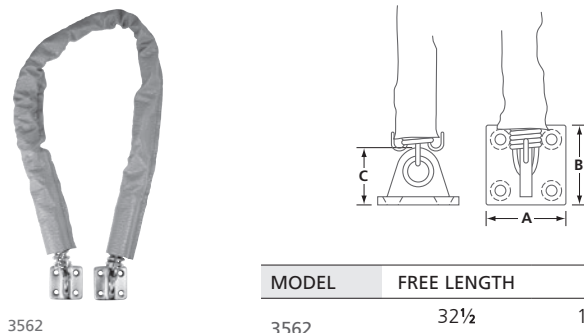

- Extra heavy-duty welded chain
- Two heavy-duty coil springs with stainless steel linkage
- Brass die-cast mounting brackets, satin chrome finish
- Grey textured vinyl cover
- Mounting hardware included: self-tapping screws

MODEL	FREE LENGTH	A	B	C	PER BOX
3562	32½ (825.5)	19/16 (39.7)	19/16 (39.7)	1¾/16 (30.2)	6

IN (MM)

