

DOOR STOPS & HOLDERS

GENERAL HARDWARE

FLEXIBLE WALL-MOUNTED DOOR STOPS

3515



3515C15

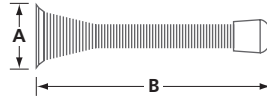

- For interior use
- Flexible steel spring
- Includes wood screw

FINISHES
15 Satin nickel

MODEL	FINISH	øA	B	/BOX	/CASE
3515	-15	$\frac{15}{16}$ (23.8)	3 (76)	50	500

IN (MM)

RIGID WALL-MOUNTED DOOR STOP

6131



6131-15

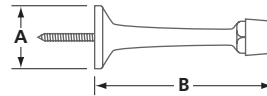

- For interior use
- Solid brass
- Integrated wood screw

FINISHES
15 Satin nickel

MODEL	FINISH	øA	B	/BOX	/CASE
6131	-15	1 (25.4)	3 (76)	25	250

IN (MM)

CONVEX & CONCAVE WALL-MOUNTED DOOR STOP

C231, C233



C231-26D



C233-26D

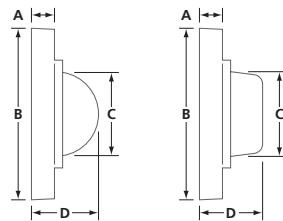

- Zinc die-cast
- Non-marking rubber
- Concealed mounting screws
- Includes wood screw, drywall anchors

FINISHES
26D Satin chrome

MODEL	FINISH	A	øB	øC	D	/BOX	/CASE
C231	-26D	$\frac{5}{16}$ (7.9)	2½ (64)	$\frac{15}{16}$ (33.3)	1 (25.4)	25	250
C233	-26D	$\frac{5}{16}$ (7.9)	2½ (64)	$\frac{15}{16}$ (33.3)	1 (25.4)	25	250

IN (MM)

DOOR STOPS & HOLDERS

GENERAL HARDWARE

DOMESTOP-LOW

C200



C200-26D

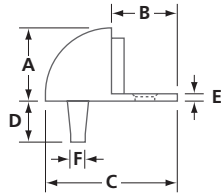

- For use with low or no threshold
- Heavy-duty zinc die-cast
- Non-marking rubber stop
- Includes wood screw and plastic anchor

FINISHES
26D Satin chrome

#T201 Riser allows easy conversion to threshold or carpet use



T201-26D
RISER

MODEL	FINISH	A	B	øC	D	E	øF	/BOX	/CASE
C200	-26D	1 (25.4)	7/8 (22.2)	1 3/4 (44.5)	3/4 (19.1)	3/32 (2.4)	3/16 (4.8)	10	200
T201	-26D	—	—	1 3/4 (44.5)	—	1/4 (6.4)	—	50	500

IN (MM)

DOMESTOP-HIGH

C218



C218-26D

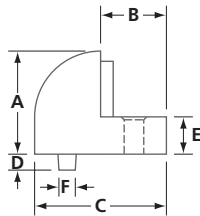

- For use with a threshold or undercut doors
- Heavy-duty zinc die-cast
- Non-marking rubber stop
- Includes wood screw and plastic anchor

FINISHES
26D Satin chrome

MODEL	FINISH	A	B	øC	D	E	øF	/BOX	/CASE
C218	-26D	1 7/16 (36.5)	7/8 (22.2)	1 3/4 (44.5)	3/4 (19.1)	1/2 (12.7)	3/16 (4.8)	10	200

IN (MM)

DOMESTOP-UNIVERSAL

C229



C229-26D

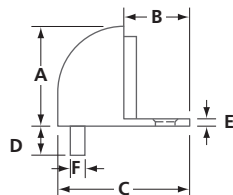

- For use with or without threshold
- Heavy-duty zinc die-cast
- Non-marking rubber stop
- Includes wood screw and plastic anchor

FINISHES
26D Satin chrome

MODEL	FINISH	A	B	øC	D	E	øF	/BOX	/CASE
C229	-26D	1 7/16 (36.5)	1 3/16 (20.6)	1 3/4 (44.5)	7/16 (11)	1/8 (3.2)	7/32 (5.6)	10	200

IN (MM)

DOOR STOPS & HOLDERS

GENERAL HARDWARE

FLOOR-MOUNTED DOOR STOP

R470



R470-26D

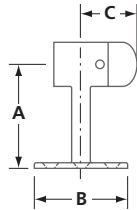

- For exterior / interior use
- Solid brass
- Non-marking rubber tip
- Includes wood screws

FINISHES

- 26D Satin chrome
- 3 Polished brass

#R470REP - Replacement rubber tip

MODEL	FINISH	A	øB	C	/BOX
R470	-26D, -3	2½ (64)	2¾ (56)	1½ (33.3)	12

IN (MM)

FLOOR-MOUNTED DOOR STOP WITH HOOK

R472



R472-26D

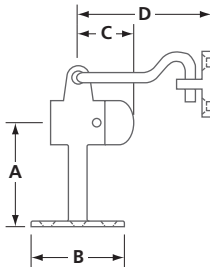

- For exterior / interior use
- Solid brass
- Non-marking rubber tip
- Includes wood screws

FINISHES

- 26D Satin chrome
- 3 Polished brass

#R470REP - Replacement rubber tip

MODEL	FINISH	A	øB	C	D	/BOX
R472	-26D, -3	2½ (64)	2¾ (56)	1½ (33.3)	2¾ (70)	10

IN (MM)

DOOR STOPS & HOLDERS

GENERAL HARDWARE

WALL-MOUNTED DOOR STOP

R474

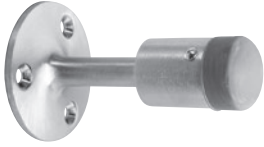

R474-26D

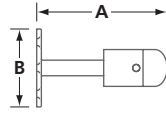

- For exterior / interior use
- Solid brass
- Non-marking rubber tip
- Includes wood screws

FINISHES

- 26D Satin chrome
- 3 Polished brass

#R470REP - Replacement rubber tip

MODEL	FINISH	A	øB	/BOX
R474	-26D, -3	3½ (89)	2¾ (56)	12

IN (MM)

WALL-MOUNTED DOOR STOP WITH HOOK

R476, R477



R476-26D

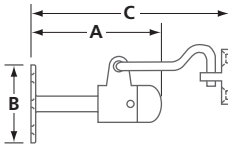

- For exterior / interior use
- Solid brass
- Non-marking rubber tip
- Includes wood screws

FINISHES

- 26D Satin chrome
- 3 Polished brass

#R470REP - Replacement rubber tip

MODEL	FINISH	A	øB	C	/BOX
R476	-26D, -3	3½ (89)	2¾ (56)	5¼ (133.4)	12

IN (MM)

DOOR STOPS & HOLDERS

GENERAL HARDWARE

PLUNGER TYPE DOOR HOLDER

1015.02



1015.02

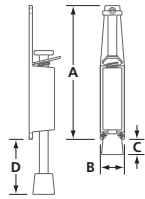

- Heavy duty zinc die-cast
- Non-marking rubber tip

#1015REP - Replacement rubber tip

MODEL	FINISH	A	B	C	D	/BOX
1015.02	Silver Paint	6½ (165)	1¾ (30.2)	7/16 (11.1)	2¾ (60)	6

IN (MM)

PLUNGER TYPE DOOR HOLDER

1026.02

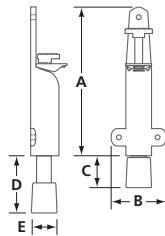

- Steel construction
- Non-marking rubber tip

#1026.00 - Replacement rubber tip

MODEL	FINISH	A	B	C	D	E
1026.02	Silver Paint	6¾ (172)	2½ (63.5)	1½ (38.1)	2¾ (70)	1½ (28.6)

IN (MM)

KICK-DOWN DOOR HOLDERS

17, 18-5



17-26D



18-5-26D

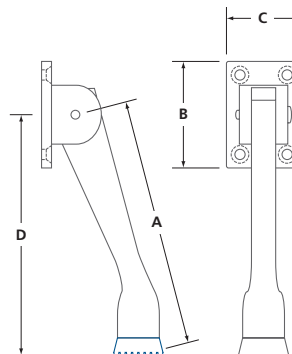

- FINISHES**
- 26D Satin chrome
 - 3 Polished brass

MODEL	FINISH	MATERIAL	A	B	C	D	REPLACEMENT TIP	SCREWS*	/BOX
17	-26D	Zinc die-cast	5 (127)	2 (50.8)	1¾ (34.9)	4¾ (121)	#17REP	Wood	10
18-5	-20D, -26D, -3	Brass	5 (127)	2 (50.8)	1¾ (34.9)	4¾ (121)	#18REP	Wood	12

IN (MM) (*) SCREWS INCLUDED

DOOR STOPS & HOLDERS

GENERAL HARDWARE

MAGNETIC DOOR HOLDER AND STOP

MDH



SMDH-26D

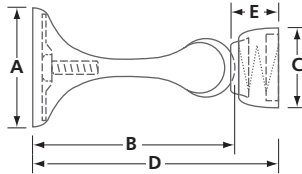

- Floor or wall mountable
- Zinc die-cast material
- Spring loaded stop
- Concealed mounting
- Mounting hardware included: wood screws

MODEL	FINISH	A	B	C	D	E	/CASE
SMDH	-15, -26D, -3	1 $\frac{3}{4}$ (44.5)	3 (76)	1 $\frac{3}{16}$ (30)	3 $\frac{3}{8}$ (93)	$\frac{3}{4}$ (19)	10
IN (MM) 15: SATIN NICKEL 26D: SATIN CHROME 3: POLISHED BRASS							

DOOR STOPS & HOLDERS

GENERAL HARDWARE

CHECK CHAINS

3548, 3550

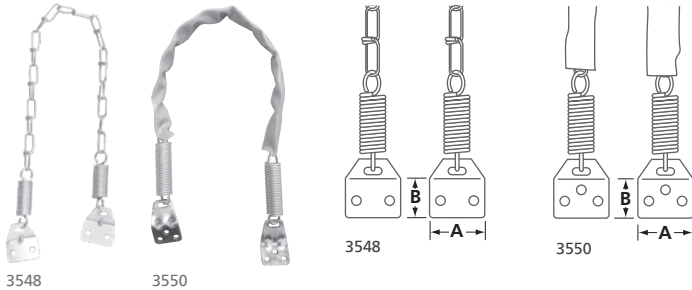

- Steel chain
- Two tension coil springs
- Stamped steel mounting brackets, zinc plated
- Mounting hardware included: self-tapping screws

#3550 - Includes grey vinyl cover, with two expansion rings

MODEL	FREE LENGTH	A	B	PER BOX
3548	24½ (622.3)	1½/16 (33.3)	7/8 (22.2)	25
3550	27½ (698.5)	1¼ (31.8)	1⅝ (28.5)	10

IN (MM)

COMMERCIAL CHECK CHAINS

3560, 3561

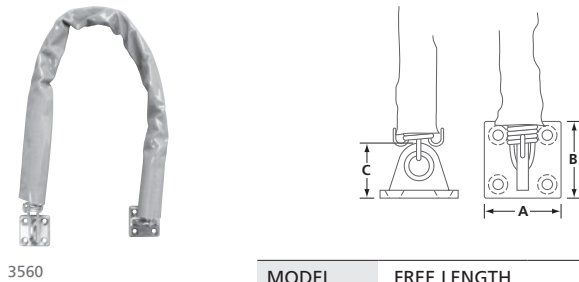

- Heavy-duty welded chain
- Two compression coil springs
- Zinc die-cast mounting brackets, zinc plated
- Grey vinyl cover
- Mounting hardware included: self-tapping screws

MODEL	FREE LENGTH	A	B	C	PER BOX
3560	27 (685.8)	19/16 (39.7)	19/16 (39.7)	1⅝ (28.6)	6
3561	31 (787.4)	19/16 (39.7)	19/16 (39.7)	1⅝ (28.6)	6

IN (MM)

HEAVY DUTY COMMERCIAL CHECK CHAIN

3562

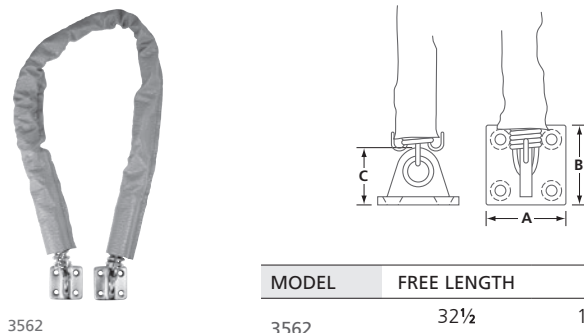

- Extra heavy-duty welded chain
- Two heavy-duty coil springs with stainless steel linkage
- Brass die-cast mounting brackets, satin chrome finish
- Grey textured vinyl cover
- Mounting hardware included: self-tapping screws

MODEL	FREE LENGTH	A	B	C	PER BOX
3562	32½ (825.5)	19/16 (39.7)	19/16 (39.7)	1¾/16 (30.2)	6

IN (MM)

HANDLES, PULLS & PLATES

GENERAL HARDWARE

MISCELLANEOUS FLUSH PULLS



2530-15

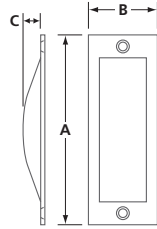

- For wood doors
- Steel
- Wood screws included

MODEL	FINISH	A	B	C	CUT-OUT DIMENSION	/BOX
2530	15	4½ (114)	1⅝ (40)	½ (12.7)	1⅝ x 3½ x ½ (33.3 x 89 x 12.7)	50

IN (MM) 15: SATIN NICKEL



3503-15

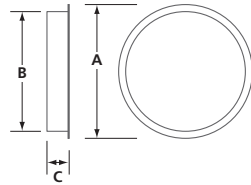

- For wood doors
- Steel
- Fasteners NOT included

MODEL	FINISH	∅A	∅B	C	CUT-OUT DIMENSION	/BOX
3503	15	2⅞ (62)	2⅞ (53.5)	⅜ (9.5)	2⅞ DIA x ½ (54 DIA x 12.7)	150

IN (MM) 15: SATIN NICKEL



4100SS

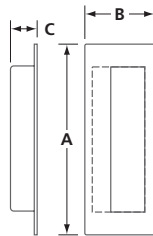

- For wood doors
- Stainless steel
- Fasteners NOT included

MODEL	FINISH	A	B	C	CUT-OUT DIMENSION	/BOX
4100SS	Stainless steel	4½ (114)	1⅝ (40)	½ (12.7)	1⅝ x 3¾ x ⅝ (33.3 x 95 x 15.9)	25

IN (MM)

HANDLES, PULLS & PLATES

GENERAL HARDWARE

ALUMINUM DOOR PULL AND PLATE

H1410



H1410

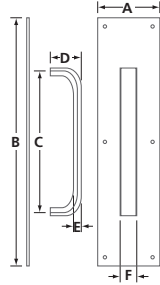

- Aluminum door pull and plate
- D-Type pull
- Handle available separately (with fasteners)
- Supplied with six # 6 x 3/4" (19.1 mm) long wood screws, two 1/4-20 UNC x 2 3/8" (60 mm) long machine screws and cup-washers

MODEL	FINISH	A	B	C	D	E	F	/CASE
H1410	Aluminum	4 (102)	16 (406)	9 (229)	2 (50.8)	15/32 (12)	1 1/16 (26.9)	32

IN (MM)

STAINLESS STEEL DOOR PULL AND PLATE

14R09P



14R09P-32D

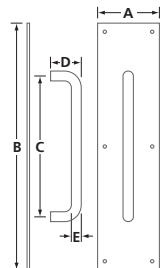

- Stainless steel door pull and plate
- Round pull
- Handle available separately (with fasteners)
- Supplied with six # 6 x 3/4" (19.1 mm) long wood screws, two 1/4-20 UNC x 2 3/8" (60 mm) long machine screws and cup-washers

MODEL	FINISH	A	B	C	D	E	/CASE
14R09P	32D	4 (102)	16 (406)	9 (229)	2 1/4 (57)	3/4 (19)	20

IN (MM) 32D: SATIN STAINLESS STEEL

HANDLES, PULLS & PLATES

GENERAL HARDWARE

ALUMINUM DOOR PULL

H1412, H1413



H1413

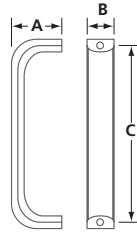

- Aluminum door pull
- D-Type pull
- Pull supplied with two 1/4-20 UNC x 2 3/8" (60mm) long machine screws and cup-washers

MODEL	FINISH	A	B	C	/CASE
H1413	Aluminum	2 (50.8)	1 (25)	9 (229)	20

IN (MM)

STAINLESS STEEL DOOR PULL

14R09P



14R09-32D

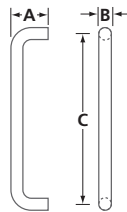

- Stainless steel door pull
- Round pull
- Pull supplied with two 1/4-20 UNC x 2 3/8" (60mm) long machine screws and cup-washers

MODEL	FINISH	A	B	C	/CASE
14R09	32D	2 1/4 (57)	3/4 (19.1)	9 (229)	20

IN (MM) 32D: SATIN STAINLESS STEEL

MULTI-PURPOSE STEEL PULL

H2381

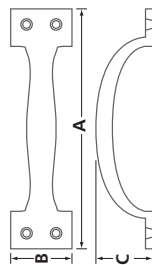

- 8" (203 mm) length
- Fasteners not included

MODEL	FINISH	MATERIAL	A	B	C	/CASE
H2381-8	Chrome Plated	Steel	8 (203)	2 1/4 (57)	2 (50.8)	10

IN (MM)

HANDLES, PULLS & PLATES

GENERAL HARDWARE

PUSH PLATES

1404

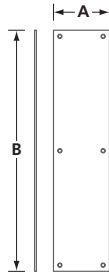

140416 AL

• Mounting hardware included: wood screws

MODEL	FINISH	MATERIAL	A	B
140416	AL	Aluminum	4 (102)	16 (406)
	BPO32	Brass		
	-32D	Stainless steel		

IN (MM)

KICK PLATES

1506, 1508, 1510, 1512



151234-AL

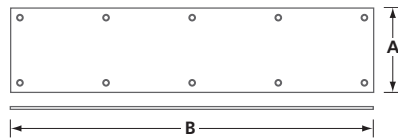

• Mounting hardware included: wood screws

MODEL	FINISH	MATERIAL	A	B
150834	AL	Aluminum	8 (203)	34½ (876)
	-32D	Stainless steel		
151034	AL	Aluminum	10 (254)	34½ (876)
	-32D	Stainless steel		
151234	AL	Aluminum	12 (305)	34½ (876)
15084L	-32D	Stainless steel	8 (203)	42½ (1080)

IN (MM)

BOLTS & HASPS

GENERAL HARDWARE

MANUAL EXTENSION FLUSH BOLT – FIRE RATED

FBUL100



FBUL100-26D

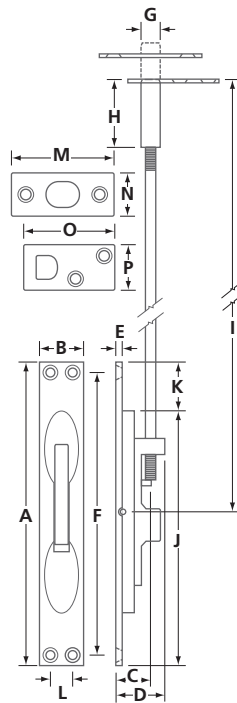

- UL listed for use with hollow metal, metal clad, steel covered composite, flush type sheet or metal swinging type fire doors.
- Not for wood fire doors
- Fits metal door preparation per ANSI A115.4-206
- Brass and steel components
- Throw: $\frac{3}{4}$ " (19 mm)
- Adjustable rod up to $\frac{7}{8}$ " (22.2 mm)
- Supplied with guide, strike plate and 12" (305 mm) $\frac{1}{4}$ -20 UNC threaded rod (see dimension "I")
- Mounting hardware included: combination machine-wood screws
- Optional rods available (not pictured):
 - #FBUL100R16 18" (457.2 mm) optional threaded rod
 - #FBUL100R22 24" (609.6 mm) optional threaded rod

MODEL	FINISH	A	B	C	D	E	F	G	H	I	J	K	L	M	N	O	P
FBUL100	-19, -26D, -3	$6\frac{3}{4}$ (171)	1 (25.4)	$\frac{3}{4}$ (19.1)	1 (25.4)	$\frac{1}{8}$ (3.2)	$6\frac{1}{4}$ (158.8)	$\frac{1}{2}$ (12.7)	$1\frac{1}{2}$ (38.1)	12 (305)	$4\frac{3}{4}$ (120)	1 (25.4)	$\frac{1}{2}$ (12.7)	$2\frac{1}{4}$ (57)	$1\frac{5}{16}$ (23.8)	2 (50.8)	1 (25.4)

IN (MM) 19: MATTE BLACK 26D: SATIN CHROME 3: POLISHED BRASS

BOLTS & HASPS

GENERAL HARDWARE

AUTOMATIC EXTENSION FLUSH BOLT

FB610M



FB610M-32D

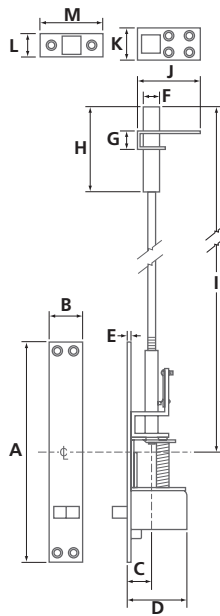

- UL labeled and rated only for hollow metal doors up to and including 3 hrs. Conforms to UL 10C and UBC 7-2-1997
- Top and bottom flush bolts for use on metal doors measuring up to 4 ft. (1219 mm) wide and 8 ft. (2438 mm) high
- Fits standard and ANSI preparation for metal doors
- Steel components
- Fully automatic, when active door is opened, inactive door is free
- Maintains inactive door locked in case of fire
- Supplied with bolt guide and door strike
- Mounting hardware included: machine and combination Machine-wood screws

MODEL	FINISH	A	B	C	D	E	F	G	H	I	J	K	L	M
FB610M	-32D	6 ³ / ₄ (171)	1 (25.4)	3/4 (19.1)	17/8 (47.6)	1/8 (3.2)	1/2 (12.7)	5/8 (15.9)	2 (50.8)	12 (305)	2 (50.8)	1 (25.4)	1 (25.4)	2 1/4 (57)

IN (MM) 32D: SATIN STAINLESS STEEL

BOLTS & HASPS

GENERAL HARDWARE

MANUAL EXTENSION FLUSH BOLT

DC860

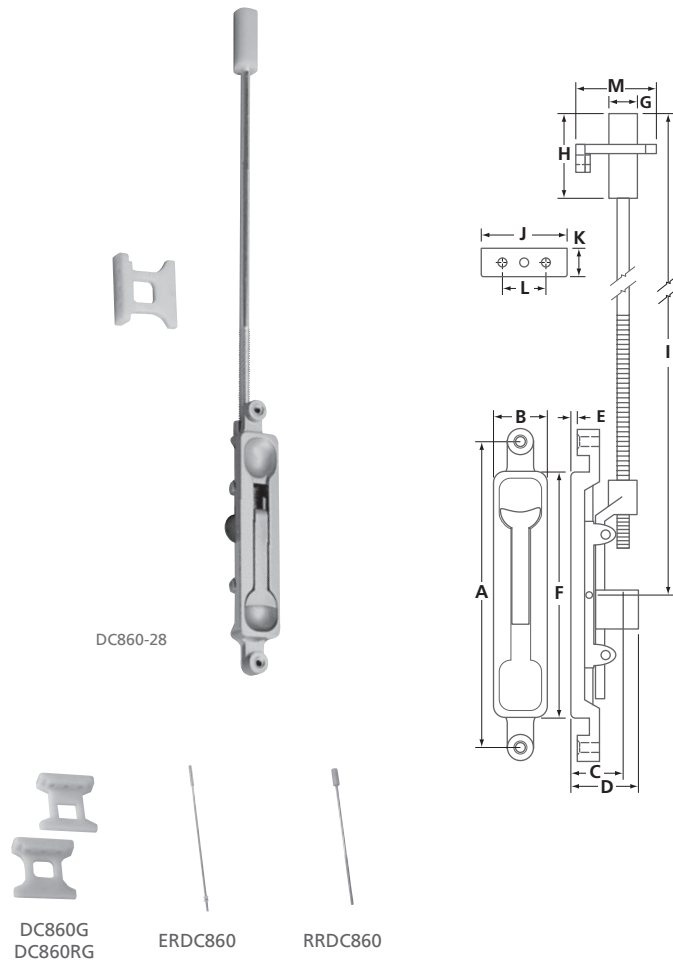

- Single bolt for aluminum doors
- 1/8" (3 mm)
- Throw: 3/8" (16 mm)
- Flush bolt faceplate with 5/32" (4 mm) radius corners
- Zinc die-cast and steel components
- Mounting hardware included: machine screws
- Supplied with threaded adaptor bushing and locking nuts
- Supplied with:
 - #RRDC860 12" (305 mm) Replacement rod
 - #ERDC860 12" (305 mm) 1/4-20 UNC extension rod
 - #DC860G / #DC860RG Nylon guides

MODEL	FINISH	A	B	C	D	E	F	G	H	I	J	K	L	M	/BOX
DC860	-15, -20D, -28	5/4 (133)	1 1/16 (23.8)	1 3/16 (20.6)	1 1/8 (28.6)	1/8 (3.2)	4 1/4 (108)	1/2 (12.7)	1 1/2 (38)	12 (305)	1 1/2 (38)	1/2 (12.7)	3/4 (19.1)	1 3/8 (34.9)	10

IN (MM) 15: SATIN NICKEL 20D: DARK BRONZE 28: ALUMINUM

BOLTS & HASPS

GENERAL HARDWARE

MANUAL EXTENSION FLUSH BOLT

DC840, 8402



DC840-15

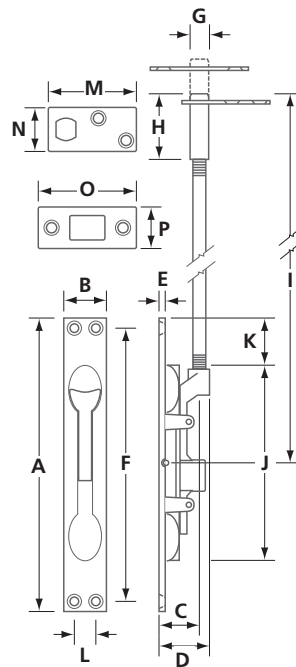

- Supplied with guide, strike plate and 12" (305mm) $\frac{1}{16}$ -18 UNC threaded rod
- Fits metal door preparation per ANSI A115.4-1981
- Zinc-diecast and steel components
- Mounting hardware included: machine and wood screws

#DC840 has a $\frac{3}{8}$ " (15.9mm) throw and $+\frac{5}{8}$ " (15.9mm) adjustment

#8402 has a $\frac{1}{2}$ " (12.7mm) throw and $\pm\frac{1}{4}$ " (6.4mm) adjustment

MODEL	FINISH	A	B	C	D	E	F	G	H	I	J	K	L	M	N	O	P	/UNIT
DC840	15	6 $\frac{3}{4}$ (171)	1 (25.4)	$\frac{3}{4}$ (19.1)	1 (25.4)	$\frac{9}{64}$ (3.6)	6 $\frac{1}{4}$ (158.8)	$\frac{7}{16}$ (11.1)	1 $\frac{1}{2}$ (38.1)	12 (305)	4 $\frac{3}{4}$ (111)	1 (25.4)	$\frac{1}{2}$ (12.7)	2 (50.8)	$\frac{15}{16}$ (23.8)	2 $\frac{1}{4}$ (57)	1 $\frac{5}{16}$ (23.8)	2
8402	26D	6 $\frac{3}{4}$ (171)	1 (25.4)	$\frac{3}{4}$ (19.1)	1 (25.4)	$\frac{9}{64}$ (3.6)	6 $\frac{1}{4}$ (158.8)	$\frac{1}{2}$ (12.7)	1 $\frac{1}{2}$ (38.1)	12 (305)	4 $\frac{9}{16}$ (116)	1 (25.4)	$\frac{1}{2}$ (12.7)	2 (50.8)	$\frac{15}{16}$ (23.8)	2 $\frac{1}{4}$ (57)	1 $\frac{5}{16}$ (23.8)	2

IN (MM) 15: SATIN NICKEL 26D: SATIN CHROME

BOLTS & HASPS

GENERAL HARDWARE

BOX-TYPE FLUSH BOLT

9123

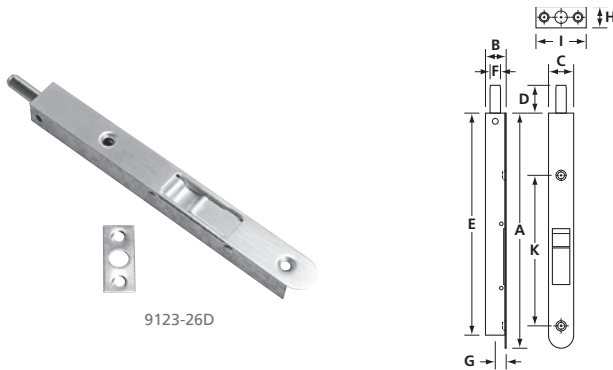

- Solid brass and steel construction material
- Box type
- Flush bolt face plate end with $\frac{3}{8}$ " (9.5 mm) radius
- Mounting screws included
- Sold individually

MODEL	FINISH	A	B	C	D	E	ϕF	G	H	I	K	/BOX
9123	15, 26D, 3	7 (178)	$\frac{5}{8}$ (16)	$\frac{3}{4}$ (19)	$\frac{7}{8}$ (22)	$6 \frac{11}{16}$ (170)	$\frac{5}{16}$ (8)	$1 \frac{1}{32}$ (8.4)	$\frac{5}{8}$ (16)	$1 \frac{1}{2}$ (38)	$4 \frac{1}{16}$ (116)	10

IN (MM) 15: SATIN NICKEL 26D: SATIN CHROME 3: POLISHED BRASS

8" COMMERCIAL SURFACE BOLT

0831

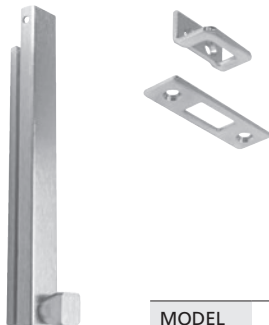

- UL listed
- Both top and bottom strikes included
- Mounting hardware included: wood screws, drywall anchors and machine screws

MODEL	FINISH	MATERIAL	A	B	C	D	E	F
0831	Satin Nickel	Steel	7 (178)	8 (203)	1 (25.4)	$1 \frac{1}{2}$ (38.1)	$\frac{1}{2}$ (12.7)	1 (25.4)

IN (MM)

DUST PROOF STRIKE

T840

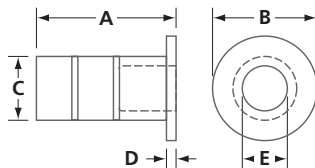

- Aluminum
- Spring loaded plunger
- Strike engagement depth up to $\frac{3}{4}$ " (19 mm)

MODEL	MATERIAL	A	ϕB	ϕC	D	ϕE	/BOX
T840	Aluminum	$1 \frac{7}{8}$ (48)	$1 \frac{3}{8}$ (35)	$\frac{27}{32}$ (21.4)	$\frac{1}{8}$ (3.2)	$\frac{9}{16}$ (14.3)	25

IN (MM)

BOLTS & HASPS

GENERAL HARDWARE

CHAIN BOLT

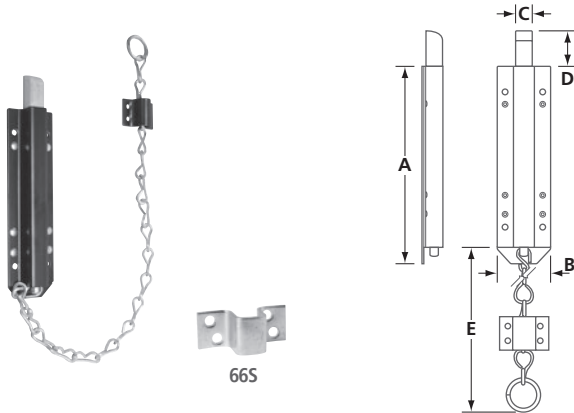

- Heavy-duty chain bolt
- Spring loaded
- Bolt reversible for in-swing and out-swing doors

#665 Surface strike for out-swing doors included; also available separately

MODEL	FINISH	MATERIAL	A	B	C SQ	D	E
66	Black	Steel	7 ³ / ₈ (187)	2 (50.8)	5 ⁸ / ₁₆ (15.9)	1 ⁵ / ₁₆ (33.3)	22 (559)

IN (MM)

FOOT BOLT

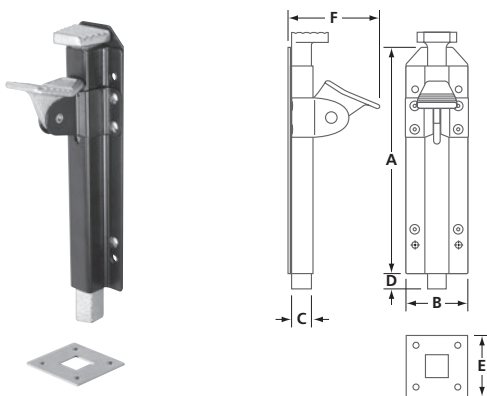

- Cast iron bolt

MODEL	FINISH	MATERIAL	A	B	C SQ	D	E SQ	F
68	Black	Steel	7 ³ / ₈ (187)	2 (50.8)	5 ⁸ / ₁₆ (15.9)	1 (25.4)	2 (50.8)	2 ⁷ / ₈ (73)

IN (MM)

BOLTS & HASPS

GENERAL HARDWARE

12" CANE BOLT – HEAVY DUTY

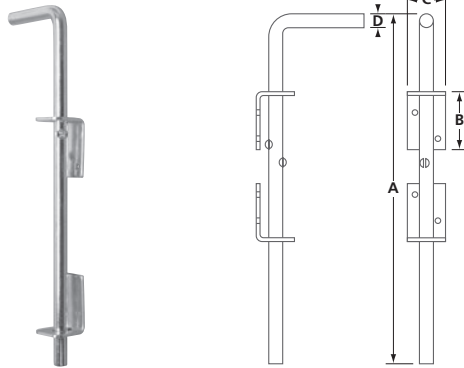

- Mounting hardware included: wood screws

MODEL	FINISH	MATERIAL	A	B	C	D
1069	Zinc plated	Steel	12 (305)	2 (50.8)	1 ⁵ / ₁₆ (33.3)	1 ⁵ / ₃₂ (11.9)

IN (MM)

SECRET GATE LATCH

H601

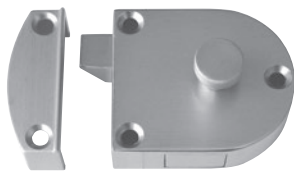

H601-15

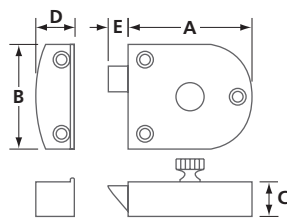

- Mounting hardware included: wood screws

MODEL	FINISH	MATERIAL	A	B	C	D	E	/BOX
H601	15	Zinc die-cast	2 ¹ / ₄ (57)	1 ¹⁵ / ₁₆ (49.2)	5/ ₈ (15.9)	1 ¹ / ₁₆ (17.5)	3/ ₈ (9.5)	10

IN (MM) 15: SATIN NICKEL

BOLTS & HASPS

GENERAL HARDWARE

STANDARD PADBOLTS

1068, 7210

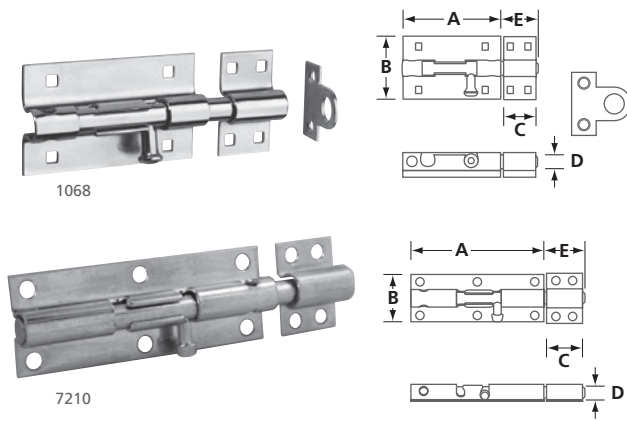

1068

- Also available retail packaged (#1068AP6C / #1068ZP8C)
- Mounting hardware included: wood screws (retail package includes carriage bolts and wood screws)

7210

- Mounting hardware included: wood screws

MODEL	FINISH	MATERIAL	A	B	C	∅D	E	MAX PADLOCK SHACKLE DIA	/BOX
1068ZP6	Zinc plated	Steel	4½ (114)	2 ¹¹ / ₁₆ (68)	1½ (38.1)	19 ³² / ₃₂ (15.1)	1 ¹³ / ₁₆ (46)	¾ (9.5)	5
1068ZP8	Zinc plated	Steel	6 (152)	2 ⁵ / ₈ (67)	1½ (38.1)	1½ (38.1)	1½ (38.1)	¾ (9.5)	5
7210ZP6	Zinc plated	Steel	4 ⁵ / ₈ (117)	1 ⁵ / ₈ (41.3)	1¼ (31.8)	7 ¹⁶ / ₁₆ (11.1)	1¼ (31.8)	¼ (6.4)	10

IN (MM)

EXTRA HEAVY DUTY PADBOLT

168

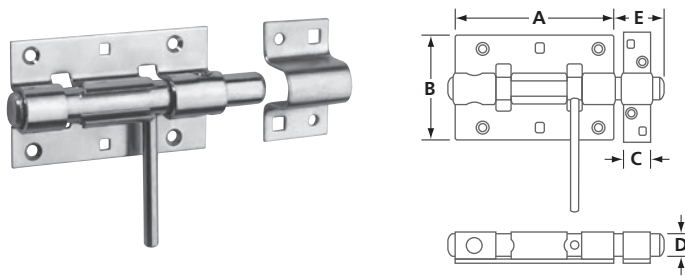

MODEL	FINISH	MATERIAL	A	B	C	∅D	E	MAX PADLOCK SHACKLE DIA	/BOX
168K	Zinc plated	Steel	5 (127)	3 (76)	1 ³ / ₁₆ (30.2)	1 ³ / ₁₆ (20.6)	2 ³ / ₁₆ (56)	½ (12.7)	5

IN (MM)

BOLTS & HASPS

GENERAL HARDWARE

STEEL BARREL BOLT

0711

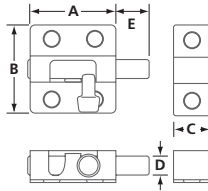
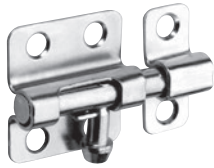

- Mounting hardware included: wood screws

MODEL	FINISH	MATERIAL	A	B	C	øD	E	/BOX
0711ZP2	Zinc plated	Steel	1 ³ / ₈ (34.9)	1 ⁷ / ₁₆ (36.5)	5/ ₈ (15.9)	5/ ₁₆ (7.9)	9/ ₁₆ (14.3)	20
0711ZP25	Zinc plated	Steel	1 ³ / ₄ (44.5)	1 ⁷ / ₁₆ (36.5)	5/ ₈ (15.9)	5/ ₁₆ (7.9)	5/ ₈ (15.9)	12
0711ZP3	Zinc plated	Steel	2 ¹ / ₈ (54)	1 ⁷ / ₁₆ (36.5)	5/ ₈ (15.9)	5/ ₁₆ (7.9)	3/ ₄ (19.1)	12
0711ZP4	Zinc plated	Steel	3 (76)	1 ¹ / ₂ (38.1)	5/ ₈ (15.9)	5/ ₁₆ (7.9)	1 (25.4)	12
0711ZP5	Zinc plated	Steel	3 ³ / ₄ (95)	1 ¹ / ₂ (38.1)	5/ ₈ (15.9)	5/ ₁₆ (7.9)	1 (25.4)	12
0711ZP6	Zinc plated	Steel	4 ⁵ / ₈ (117)	1 ¹ / ₂ (38.1)	5/ ₈ (15.9)	5/ ₁₆ (7.9)	1 (25.4)	12

IN (MM)

DOOR CATCHES

GENERAL HARDWARE

HEAVY DUTY ROLLER CATCH

01015T

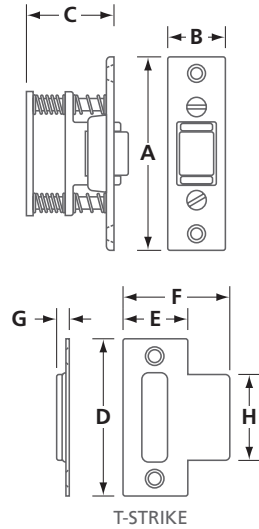

- Adjustment for door gap
- Adjustable spring tension on roller
- T-Strike included
- Mounting hardware included: wood screws

#01015 No strike included
 #01015D Includes full lip D-strike
 #01015T Includes T-strike
 #01015ASA Includes ASA-strike

MODEL	FINISH	MATERIAL	A	B	C	D	E	F	G	H	/BOX
01015T	26D	Zinc die-cast	3 ³ / ₈ (86)	1 (25.4)	1 ¹ / ₁₆ (39.6)	2 ³ / ₄ (70)	1 ¹ / ₃₂ (29.4)	1 ⁷ / ₈ (47.6)	1 ¹ / ₁₆ (1.5)	1 ¹ / ₂ (38.8)	10

IN (MM) 26D: SATIN CHROME

BALL CATCH – BRASS

01014

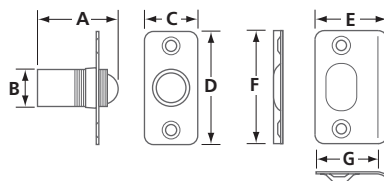

- For wood door and frame
- Adjustable spring tension
- Adjustable for frame gap
- Strike for 1³/₈" (35 mm) doors; ⁷/₃₂" (5 mm) rounded corners
- Mounting hardware included: wood screws

MODEL	FINISH	MATERIAL	A	øB	C	D	E	F	G	/BOX
01014	15	Brass	1 ¹ / ₂ (38.8)	1 ¹ / ₁₆ (17.8)	1 (25.4)	2 ¹ / ₈ (54)	1 ³ / ₈ (35.4)	2 ¹ / ₈ (54)	1 ³ / ₁₆ (30)	20

IN (MM) 15: SATIN NICKEL

DOOR CATCHES

GENERAL HARDWARE

BALL CATCH – DRIVE IN

01003

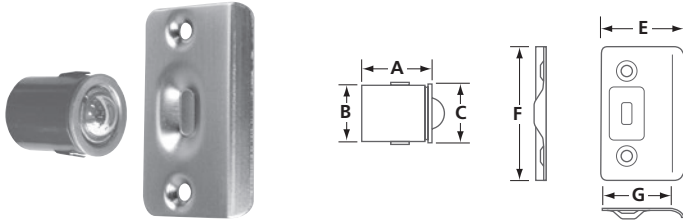

- For wood door and frame
- Zinc die-cast body, with steel ball and strike
- Fits into 1" (25.4 mm) bore
- Adjustable for frame gap
- Strike for 1³/₈" (35 mm) doors; 7¹/₃₂" (5 mm) rounded corners
- Mounting hardware included: wood screws

MODEL	FINISH	MATERIAL	A	ø B	ø C	E	F	G	/BOX
01003	26D	Zinc die-cast	1 ³ / ₁₆ (30.1)	3 ¹ / ₃₂ (24.6)	1 (25.4)	1 ³ / ₈ (34.9)	2 ¹ / ₄ (57)	1 ³ / ₁₆ (30)	50

IN (MM) 26D: SATIN CHROME

DOOR SECURITY

GENERAL HARDWARE

DOOR VIEWERS

DV



DV160

- Solid brass door viewer
- UL 20 minute fire rating for labelled fire doors
- Polished glass and acrylic optical lenses
- Individually boxed

MODEL	FINISH	DOOR THICKNESS	Ø BORE	FIRE RATING	VISION ANGLE	/BOX
DV160	26, 26D, 3	1 ³ / ₈ – 2 (35–51)	12mm	20 min	160°	25

IN (MM) 26: POLISHED CHROME 26D: SATIN CHROME 3: POLISHED BRASS

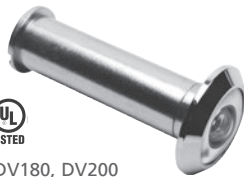

DV180, DV200

- Solid brass door viewer
- UL 20 minute fire rating for labelled fire doors
- Polished glass and acrylic optical lenses
- Individually boxed

MODEL	FINISH	DOOR THICKNESS	Ø BORE	FIRE RATING	VISION ANGLE	/BOX
DV180	26D	1 ³ / ₈ – 2 (35–51)	14mm	20 min	180°	25
DV200	26D	1 ³ / ₈ – 2 ¹ / ₄ (35–57)	14mm	20 min	200°	10

IN (MM) 26D: SATIN CHROME

DOOR VIEWER – LARGE

DS300



DS300CHR-COVER

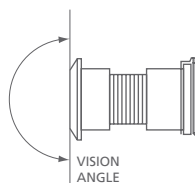

- Zinc die cast door viewer
- Polished glass optical lens
- Viewer is intended for use with classified fire door rated up to and including 90 minutes
- Detachable lens cover is included
- Individually boxed
- Replacement lens cover: #DS300CHR-COVER

MODEL	FINISH	DOOR THICKNESS	Ø BORE	FIRE RATING	VISION ANGLE	/BOX
DS300	BP, CHR	1 ³ / ₈ – 2 (35–51)	³ / ₃₂ (24.5)	90 min	180°	15

IN (MM) BP: POLISHED BRASS CHR: CHROME

DOOR SECURITY

GENERAL HARDWARE

REVOLVING DOOR VIEWER

511

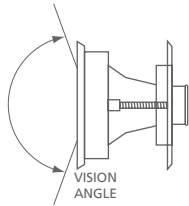
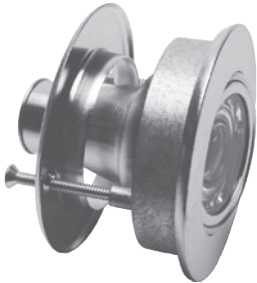

- Revolving door viewer
- Stamped brass components
- Crystal optical glass lenses
- Individually boxed

MODEL	FINISH	DOOR THICKNESS	Ø BORE	FIRE RATING	VISION ANGLE	/UNIT
511	-26D	1 ³ / ₈ – 1 ³ / ₄ (35–44)	2 ³ / ₈ (60.3)	—	140°	1

IN (MM) 26D: SATIN CHROME

DOOR SECURITY

GENERAL HARDWARE

DOOR GUARD

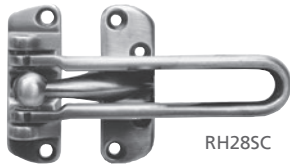

RH28SC

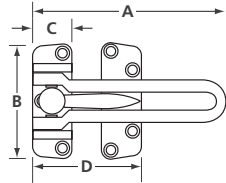

RH28EP28

- High security zinc alloy door guard, supplied with mounting screws
- Protective aluminum edge plates for door guard RH28EP, $\frac{9}{16} \times 1 \times 1\frac{3}{16}$ " (14.3 x 25.4 x 30 mm) sold separately

MODEL	FINISH	A	B	C	D	/BOX
RH28	SC	$4\frac{1}{4}$ (108)	$2\frac{7}{16}$ (62)	$1\frac{3}{16}$ (21)	$2\frac{5}{8}$ (67)	10

IN (MM) SC: SATIN CHROME

LATCH PROTECTORS



307



311P



311LP

- Unit covers the latch area of the door, thereby providing added protection from burglaries, vandalism or abuse
- For use with maximum $2\frac{1}{2}$ " (63.5 mm) diameter mortise or $3\frac{5}{8}$ " (92.1 mm) cylindrical lock
- Made of heavy gauge steel
- 311P and 311LP are supplied with security pin to prevent separation of the door and frame
- Individually packed and supplied with carriage bolts and nuts

#311BOLTKIT Bolt kit for exterior doors with weatherstripping

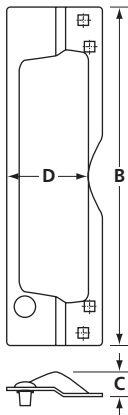

MODEL	FINISH	A	B	C	D	E	/CASE
307				—			
307S	28	7 (177.7)	3 (76.3)	$2\frac{3}{4}$ (70.0)	$\frac{9}{32}$ (7)	$\frac{3}{4}$ (19)	40
307L				$2\frac{9}{16}$ (65.0)			
311P				—			
311S	28	$10\frac{7}{8}$ (276.5)	$3\frac{3}{32}$ (78.2)	$2\frac{7}{8}$ (73.0)	$\frac{9}{32}$ (7)	$\frac{3}{4}$ (19)	40
311LP				$2\frac{5}{8}$ (67.0)			

IN (MM) 28: ALUMINUM PAINT

DOOR SECURITY

GENERAL HARDWARE

WRAP AROUND PLATES

WP4B, WP9B, WDC12B, WDCP12B



WP4



WP9



WDC12

- For cylindrical locks with 2¹/₈" (54mm) bore hole
- For 1³/₄" (45mm) door thickness
- 22 gauge stainless steel
- Latch faceplate recess fits:
1¹/₈ x 2¹/₄" (28.5 x 57mm) latches
- Mounting screws included

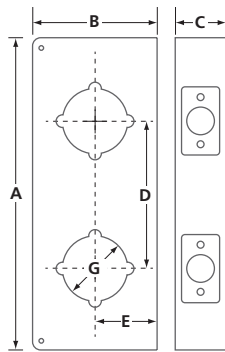

MODEL	A	B	C	D	E	∅G
WP4BA-32D	4 ¹ / ₂ (114.5)	4 (102)	1 ³ / ₄ (45)	—	2 ³ / ₈ (60)	2 ¹ / ₈ (54)
WP4BB-32D		4 ¹ / ₄ (108)			2 ³ / ₄ (70)	
WP9BA-32D	9 (229)	4 (102)	1 ³ / ₄ (45)	—	2 ³ / ₈ (60)	2 ¹ / ₈ (54)
WP9BB-32D		4 ¹ / ₄ (108)			2 ³ / ₄ (70)	
WDC12BA-32D	12 (305)	4 (102)	1 ³ / ₄ (45)	5 ¹ / ₂ (140)	2 ³ / ₈ (60)	2 ¹ / ₈ (54)
WDC12BB-32D		4 ¹ / ₄ (108)			2 ³ / ₄ (70)	

IN (MM) 32D: SATIN STAINLESS STEEL