

# **PARAMOUNT**

---

## **BB1068 / BB1099 SERIES**

### **BALL BEARING TEMPLATE BUTT HINGES HEAVY WEIGHT**

- Non-handed
  - Base material: steel for series BB1068, stainless steel for series BB1099
  - High grade plated finishes
  - Standard non-rising non-removable pin (NRP)
  - Standard flat top and knock-out bottom tips
  - Quality wood screws and undercut machine screws included
  - Standard template hole pattern conforming to ANSI standard A156.7
- 



---

BB1068 & BB1099 series hinges are full mortise heavy-duty hinges. Made from the highest quality materials. These hinges are suitable for high traffic industrial door applications and are recognized for value while delivering lasting performance.

---

# BB1068 / BB 1099 SERIES HINGES

## SPECIFICATION

All full mortise heavy-duty ball bearing template butt hinges shall be BB1068 / BB1099 series. BB1068 series hinges shall be made from select quality steel base materials and high grade plated finishes. BB1099 series hinges shall be made of Type 304 Stainless Steel. Hinges shall be of heavy weight, have 5 knuckles, 4 Slimline ball bearings with non-rising non-removable pin (NRP) security and standard flat top and knock-out bottom tips. Hinges shall have four square corners. Hinges shall be non-handed and supplied with all necessary wood and undercut machine mounting fasteners.

## SELECTION GUIDE

MODEL NUMBER	SIZE	FINISH	MACHINE SCREWS	WOOD SCREWS	QTY PER BOX / CASE	CASE LBS / KG	
BB1068-454*	4 1/2 (114.3) x 4 (101.6)	P, 3, 26D,	#12-24 x 1/2 (12.7)	#12 x 1 1/4 (31.8)	3 / 48	64.7 / 29.4	
BB1099-454*		32D					
BB1068-4545	4 1/2 (114.3) x 4 1/2 (114.3)	P, 3*, 26D,				78.8 / 35.8	
BB1099-4545		32D					
BB1068-545*	5 (127) x 4 1/2 (114.3)	P, 3, 26D,					85.8 / 39.0
BB1099-545*		32D					
BB1068-55	5 (127) x 5 (127)	P, 3*, 26D*,				85.8 / 39.0	
BB1099-55*		32D					

ANSI equivalence for reference only: steel - A8111, stainless steel - A5111

ORDERING EXAMPLE: **BB1068** | **-4545** | **-26D** | **-NRP**  
SERIES | SIZE | FINISH | FEATURE

## SIZE CHART

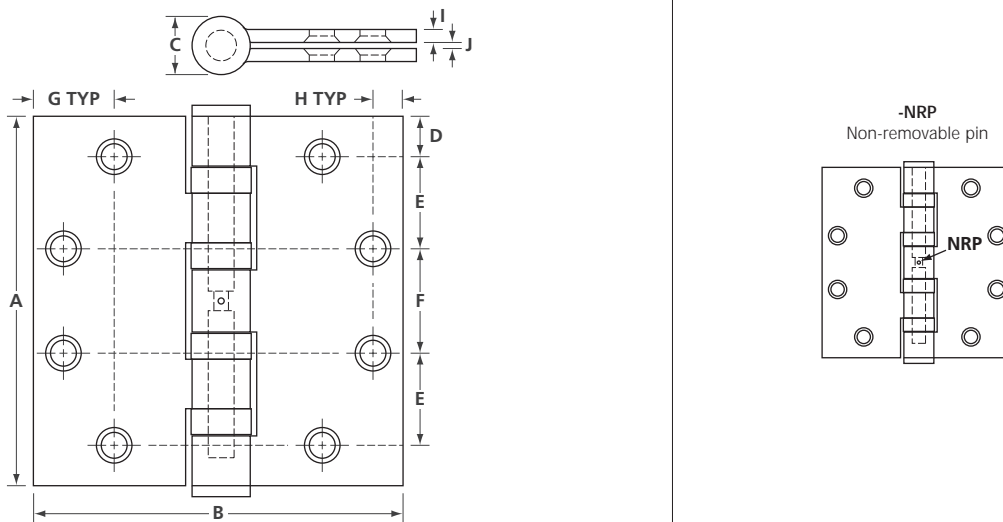

SIZE	A	B	C	D	E	F	G	H	I	J
454	4 1/2 (114.3)	4 (101.6)	23/32 (18.3)	1/2 (12.7)	1 1/8 (28.6)	1 7/32 (31.3)	1 (25.4)	3/8 (9.5)	0.180 (4.6)	1/16 (1.8)
4545		4 1/2 (114.3)							3/4 (19)	
545	5 (127)	5 (127)	3/4 (19)		1 1/4 (31.8)	1 15/32 (37.7)		0.190 (4.8)		
55		5 (127)	3/4 (19)		1 1/4 (31.8)	1 15/32 (37.7)		0.190 (4.8)		