

### DEADBOLT LOCK

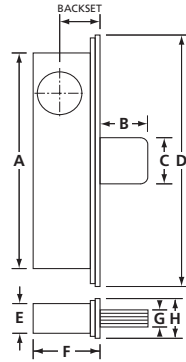

- Zinc plated steel construction
- Laminated steel pivot bolt
- Non-handed
- Backset options: 7/8" (22.2mm), 31/32" (24.6mm) or 1 1/8" (28.6mm)
- Lock accepts standard 1 5/32" (29.4mm) diameter mortise cylinder with cam A
- Flat anodized aluminum or duronodic faceplate and mounting screws included
- Finish: aluminum (AL) and duronodic (DU)

MODEL NUMBER	BACKSET	A	B	C	D	E	F	G	H	QTY PER CASE	WEIGHT LBS / KG
DB2101	7/8 (22.2)	6 (152.7)	1 3/8 (35.1)	1 3/8 (34.4)	6 7/8 (174.6)	29/32 (22.8)	1 1/2 (38)	5/8 (15.3)	1 (25.4)	25	32.3 / 14.7
DB2102	31/32 (24.6)						1 5/8 (41.2)				
DB2103	1-1/8 (28.6)						1 3/4 (44.2)				

### HOOKBOLT LOCK

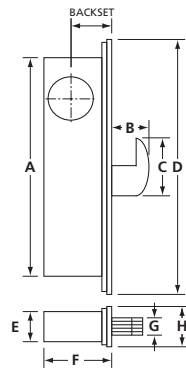

- Zinc plated steel construction
- Laminated steel pivot bolt
- Non-handed
- Backset options: 31/32" (24.6mm) or 1 1/8" (28.6mm)
- Lock accepts standard 1 5/32" (29.4mm) diameter mortise cylinder with cam A
- Flat anodized aluminum or duronodic faceplate and mounting screws included
- Finish: aluminum (AL) and duronodic (DU)

MODEL NUMBER	BACKSET	A	B	C	D	E	F	G	H	QTY PER CASE	WEIGHT LBS / KG
HB2302	31/32 (24.6)	6 (152.8)	13/16 (20.1)	1 1/4 (31.8)	6 7/8 (174.6)	29/32 (22.9)	1 5/8 (41.2)	5/8 (15.5)	1 (25.4)	25	28.6 / 13.0
HB2303	1-1/8 (28.6)						1 3/4 (44)				

ORDERING EXAMPLE: **DB2** SERIES | **30** LOCKTYPE | **2** BACKSET | **-1** FACEPLATE | **AL** FINISH

### MORTISE BOTTOM RAIL DEADBOLT

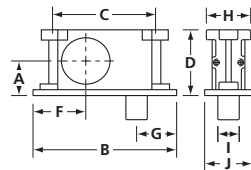
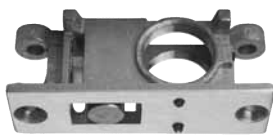

- Solid brass lock for bottom rail on glass door
- Lock accepts standard 1 5/32" (29.4 mm) diameter mortise cylinder with cam B (Yale type)
- 5/8" (16 mm) diameter bolt x 19/32" (15 mm) throw
- 1/4" x 2" (51 mm) long flat head mounting screws are required

MODEL NUMBER	A (backset)	B	C	D	E	F	G	H	I	J	PER CASE	WEIGHT LBS / KG
3505	27/32 (21.4)	4 5/32 (105.3)	3 1/2 (89.0)	1 9/16 (39.6)	5/8 (16.0)	1 7/16 (36.6)	1 1/2 (38.0)	1 11/32 (34.2)	5/8 (15.7)	1 5/16 (33.1)	50	40.5 / 18.4

AL - Aluminum DU - Duronodic

Dimensions unless specified otherwise are: Inches (Millimeters)

# SWINGING DOOR HARDWARE

## SECURITY & SPECIALTY PRODUCTS

**PARAMOUNT**

### DEADLATCH LOCK

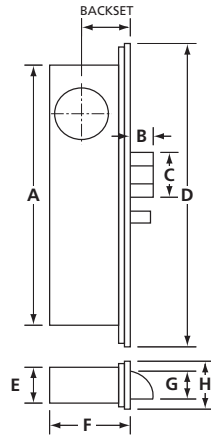

- Zinc plated steel construction
- Chrome plated latch bolt with Delrin insert for smooth, quiet latching
- Zinc alloy auxiliary bolt
- Left or right handed, field reversible
- Backset options: 31/32" (24.6mm) or 1 1/8" (28.6mm)
- Lock accepts standard 1 5/32" (29.4mm) diameter mortise cylinder with cam A
- Keyed or thumbturn cylinder controlled latch dogging
- Radius anodized aluminum or duronodic faceplate and mounting screws included
- Other faceplates available
- Finish: aluminum (AL) and duronodic (DU)

MODEL NUMBER	HANDING	BACKSET	A	B	C	D	E	F	G	H	QTY PER CASE	WEIGHT LBS / KG
DL2412-2	LH	31/32 (24.6)	5 27/32 (148.1)	1/2 (12.7)	1 (25.3)	6 13/16 (173)	7/8 (22.2)	1 5/8 (41)	5/8 (16.2)	1 (25.4)	25	28.6 / 13.0
DL2422-2	RH											
DL2413-2	LH	1 1/8 (28.6)						1 3/4 (44.2)				
DL2423-2	RH											

### HEAVY-DUTY DEADLATCH LOCK

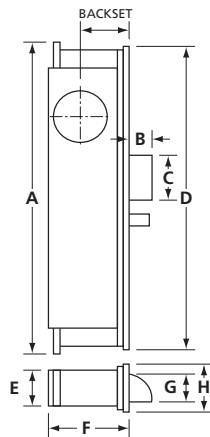

- Heavy-duty zinc plated steel construction
- Adjustable mounting studs for easy lock alignment
- Solid zinc alloy latch bolt
- Zinc alloy auxiliary bolt
- Left or right handed, field reversible
- Backset options: 31/32" (24.6mm) or 1 1/8" (28.6mm)
- Lock accepts standard 1 5/32" (29.4mm) diameter mortise cylinder with cam A
- Keyed or thumbturn cylinder controlled latch dogging
- Radius anodized aluminum or duronodic faceplate and mounting screws included
- Other faceplates available
- Finish: aluminum (AL) and duronodic (DU)

MODEL NUMBER	HANDING	BACKSET	A	B	C	D	E	F	G	H	QTY PER CASE	WEIGHT LBS / KG
DL2512-2	LH	31/32 (24.6)	7 (177.8)	1/2 (12.7)	1 (25.4)	6 13/16 (173)	7/8 (22.5)	1 5/8 (41.2)	5/8 (15.7)	1 (25.4)	25	28.6 / 13.0
DL2522-2	RH											
DL2513-2	LH	1 1/8 (28.6)						1 3/4 (44)				
DL2523-2	RH											

**ORDERING EXAMPLE:** DL2 | 41 | 2 | -2 | -AL  
SERIES LOCKTYPE & HANDLING BACKSET FACEPLATE FINISH

AL - Aluminum DU - Duronodic

Dimensions unless specified otherwise are: Inches (Millimeters)

R3 06/13